

## Outdoor 8x2MP Stitched 360° Panoramic Network IR Dome Camera

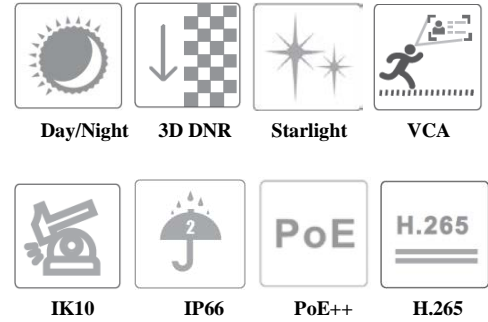

## VTC-R208



### Features

- Eight 1080P video modules to stitch one 16MP, 360° surrounded video stream
- 16MP (4096×1800×2) resolution, 25/30fps real-time
- One IP address, One video interface, similar with one IPC, easy to learn, manage and deploy
- One Cable (PoE++), One bracket and One Panoramic camera, easy to install, reducing TOC(Total own cost)
- Advanced real-time stitching technology without geometry, brightness and color gap
- 6<sup>th</sup> gen Starlight & HDR technology (0.008lux@F2.0 AGC on) provides vivid color at most scenarios.
- 360°(H)×90°(V) circular IR illumination, up to 20m in radius.
- Programmable VCA: human/vehicle detection, intrusion, line crossing, etc.
- 4Tops Deep-learning AI engine, 8Gb DDR for more AI algorithm updates.
- Alarm driven by multi-rules: line crossing, intrusion, device error, etc.
- ONVIF specifications, interoperability between network video products regardless of manufacturer
- Full Interface: RJ45, SD Card, Alarm, Audio, Reset
- - 30°C~55°C (-22 °F ~ 131 °F), Built-in heater and fan, IP66 waterproof, IK10, Metal case.
- Support PoE++(802.3.bt, class6) and DC24V / AC24V
- Support Virtual reality (VR) linkage, e-tags, e-map application with TVT VMS

### Application

Install about 4-6m height outdoor/indoor to cover a large area with 20m in radius. It is suitable for large public area safety, such as Subway station, Airport, Cathedral, City mall, Plaza, School, Conference center, etc.

## Specifications

Camera Module	
Image sensor	1/2.8" progressive scan CMOS image sensor x8
Mini. Illumination	Color : 0.008Lux @ (F2.0,AGC ON) ; B/W : 0.008Lux @ (F2.0 , AGC ON);0Lux with IR
Image setting	Image vertical rotation,Saturation, Brightness, Contrast, Sharpness, AGC, and AWB adjusted by client software/browser
Shutter Speed	1/1 s – 1/100,000 s
White Balance	Auto/Manual/Indoor/Outdoor
Gain	Auto/Manual
Day & Night	IR Cut filter
Privacy Mask	8 Programmable privacy masks
Image Enhancement	3D DNR, Digital zoom, Logo picture Overlay
Vertical Rotation	Manual adjustment, 8 pitches, 45°per pitch
Lens	
Focus length	3.3mm,x8
Aperture	F2.0
FOV	Panoramic image: Horizontal FOV: 2x180°(360°) ; Vertical FOV: 85°
Working distance	1.0m ~ INF
IR	
IR Range	20m in radius,360°(H) ×90°(V)
Smart IR	Yes
Network	
Max Resolution	8192 ×1800, 25/30fps
Main stream	8192 ×1800 , 3840 × 1680 , 2784 × 1200 (1~30fps)
Sub stream:	2048 × 896, 1280 × 560 , 704 × 320 (1~30fps)
Third stream:	704 × 320 ( 1~30fps )
Video compression	H.265/H.264/MJPEG
Audio compression	G.711 A/U
Protocols	HTTP, HTTPS, IPv4/IPv6, 802.1x, QoS, FTP, SMTP, UPnP, SNMP,DNS, DDNS, NTP, RTSP, RTCP, RTP, TCP/IP, UDP, DHCP, PPPoE
Simultaneous live view	Up to 6 channels
User / Host	Up to 16 users, 3 levels: Administrator, Advanced User and Normal User
Security Measures	User authentication (ID and PW), Host authentication (MAC address); HTTPS encryption, IEEE802.1x port-based network access control; IP address filtering
Smart Features	
Basic event	Motion detection, video tampering alarm, exception (network disconnected, IP address conflict, SD full, SD error)
Smart Detection	Up to 8 regions configurable: Human/vehicle detection and classification, Face comparison, Intrusion detection, Line crossing detection, Region entrance detection, Region exiting detection, Scene change detection, etc.
ROI	Up to 4 regions configurable
Alarm Linkage	Upload to FTP/Memory card, send email, trigger alarm output, trigger recording, trigger snapshot
System Integration	
Alarm Interface	1CH alarm input; 1CH alarm output
Audio Interface	1CH audio input, 2 to 2.4v[p-p] 1kΩ±10%; 1CH audio output (line out), impedance: 600Ω
Network Interface	1 RJ45 10M/100M/1000M Adaptive Ethernet (Support PoE++(802.3.bt,class 6))
Storage	Built-in memory card slot, support microSD/SDHC/SDXC, up to 256G
API	ONVIF, support SDK and third-party management platform

Client	NVR N9000 1.4.6, NVMS 2.0(Support VR, e-Tag, e-map application)
Web Browser	IE8-11
<b>General</b>	
Power	AC24V,DC24V,PoE++ (802.3.bt, class 6), (Max 45W, include IR on, Fan on and Heater on)
Working condition	-30°C ~ 55°C (-22 °F ~ 131 °F),90%RH less (non-condensing),Cold start at - 20°C
Storage condition	-40°C ~ 70°C ;≤ 95% RH
Protection	IP 66, IK10, 6000V Lightning Protection, Surge Protection and Voltage Transient Protection
Material	Camera body: Aluminum Alloy; Bubble and IR cover: Plastic
Dimensions	Φ 273mm x H 180mm( Φ 10.7" x 7")
Weight	Net weight Approx. 2.0Kg(4.4 lb)
Certification	IK10(exclude plastic cover), IP66,ROHS, CE, FC

## Ordering Information

Camera	VTC-R208	Outdoor 8x2MP Stitched 360° Panoramic Network IR Dome Camera, with power adaptor, bracket, IP66/IK10
--------	----------	--

## Dimension

Unit: mm (inch)

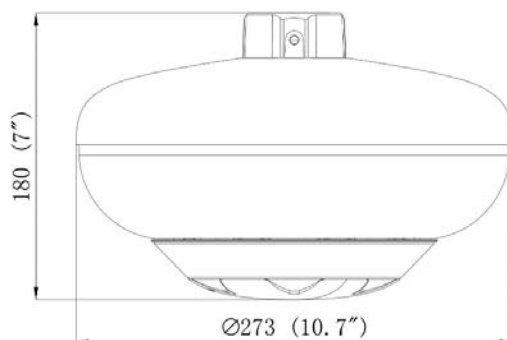

## Accessories

### Includes:



MKAC-76-243000M  
AC24V/3A Power Adapter



VTC-YZJ0807  
Ceiling Mount

### Optional:

#### IR-LED illumination enabled:



VTC-YZJ0314  
Wall mounting bracket (1m)



VTC-YZJ0315  
Pole mounting bracket (1m)



VTC-YZJ0316  
Corner mounting bracket (1m)

#### IR-LED illumination Disabled:



VTC-YZ0308  
Wall mounting bracket (35cm)



VTC-YZ0309  
Pole mounting bracket (40cm)



VTC-YZ0310  
Corner mounting bracket (50cm)

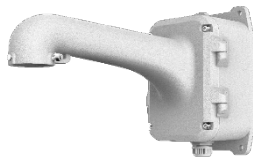

VTC-YZJ0311  
Wall mounting bracket (40cm)  
with junction box



VTC-YZJ0312  
Pole mounting bracket (45cm)  
with junction box



VTC-YZJ0313  
Corner mounting bracket (55cm)  
with junction box

\*Common PTZ brackets are not recommended for this product.  
Please contact your sales for more information about production details.